

# WOOSAH

## IN-POOL LOUNGE CHAIR



### SPLASH Series



The most comfortable in-pool chair is here. Take a seat in the Woosah Chair and let your shoulders and arms relax. Now take a deep breath and say "Wooooo-saaaaah" while slowly exhaling. Repeat until you feel the tension wash away.

The ergonomic contouring of the seat makes for a very comfortable chair. The seat is made with soft contoured, rotationally molded polyethylene that can withstand sun, rain, snow, ice, and pool chemicals.

- Designed for in-pool use and has zero metal components.
- Great ergonomic seat profile and tall backrest.
- Supports up to 350 lbs
- Easy to add to the pool and easy to remove from the pool. No screw plugs to deal with.
- Leg bases are rounded for use in all types of pools, including vinyl liner.





EASY TO MOVE



# WOOSAH IN-POOL LOUNGE CHAIR



## PRODUCT INFO

#SPLWOOSAHBX\_:\_: - Splash Woosah Chair

#SPLWOOSAH2BX\_:\_: - Splash Woosah Chair, 2 Chair Combo Pack in 1 Box

Woosah chair gives the user an “Adirondack chair” seat height for optimal comfort when used on the pool and on the patio. If you have a sun shelf of 13” or less, Woosah will work without any additional weight. For water depths between 13” to 18”, Woosah will resist floating when two 4lbs weights are added into the base. Woosah is easy to place into the pool and remove from the pool. There are no drain plugs that trap water into the core of the chair, Woosah has air/drain holes, allowing pool water to constantly recirculate within the core of the chair and allowing water to drain from the core when removed from the pool.

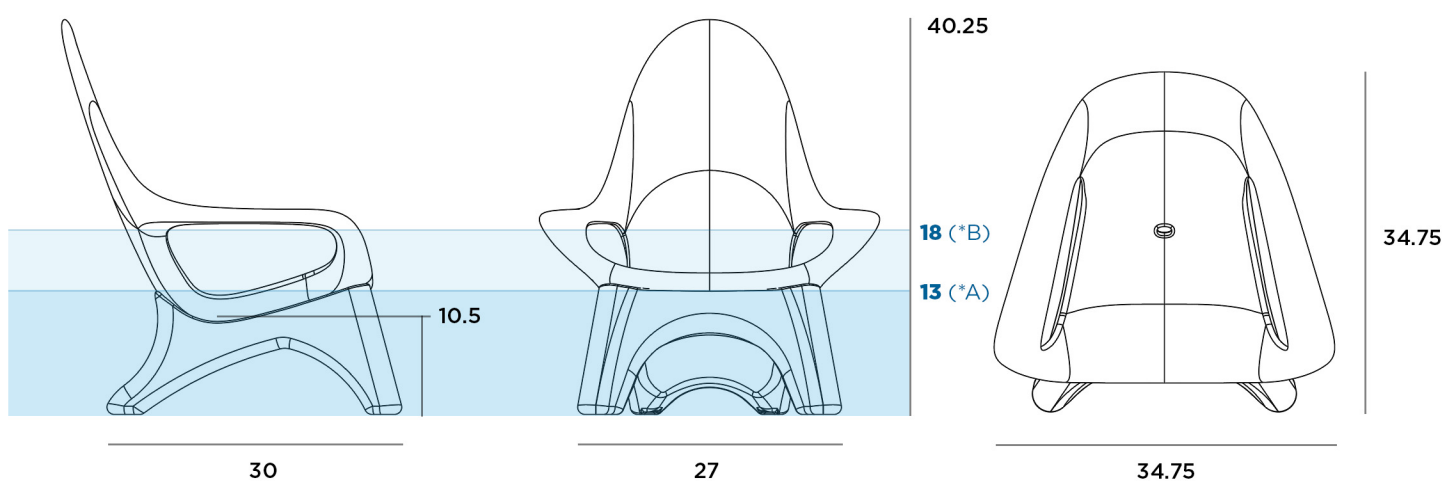

\*A: Max water depth without optional weights.

\*B: Max water depth with two 4lbs weights added.

## STANDARD COLORS

2 digit color code corresponds to the blank spaces in the product SKUS.



White Granite (WG)

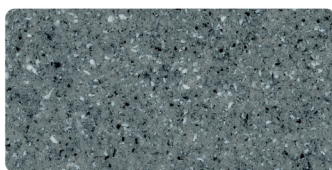

Gray Granite (GG)

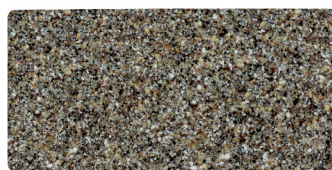

River Rock (RR)

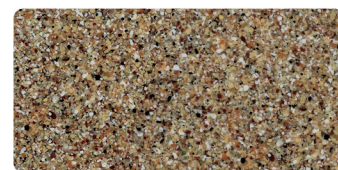

Desert Sandstone (DS)



Yellow (YE)



Surf Blue (SB)



Light Blue (LB)

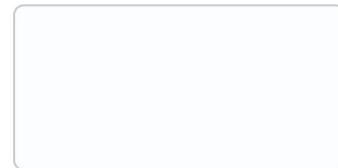

White (WH)

## INCLUDED PARTS (NO TOOLS REQUIRED)



Seat

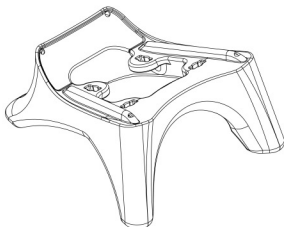

Chair Base

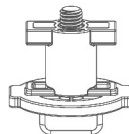

Connector (x4)

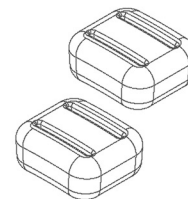

Optional Weights  
(Not Included)

\*\*13" water depth or less: no additional weights are needed. 13" to 18" water depth: purchase two 4lbs weights (plastic coated lead is recommended). Add one weight into each of the front legs of the base prior to assembly.

## Step 1

Spread out a towel or moving blanket. You can also cut the sides of the box so the box spreads out flat on the ground. This is to protect the seat and the base from scratching during assembly.

## Step 2

Place the plastic seat upside down on the towel or blanket so the bottom of the chair is facing towards you.

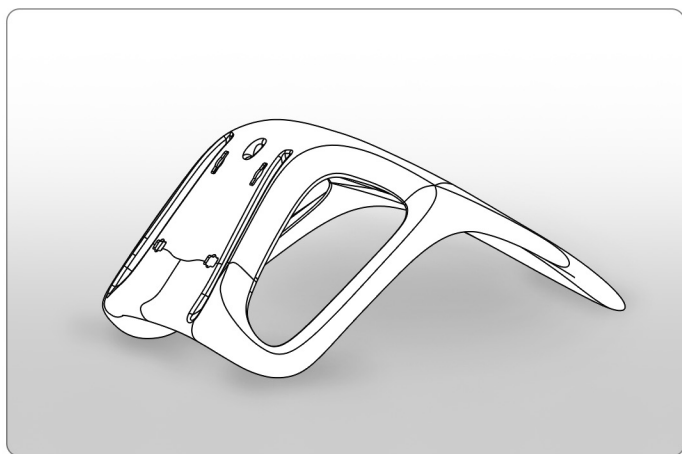

Diagram: Step 2

## Step 3

Turn the connector screw knob counter clockwise to expand each connector. Align the raised ridges on the base with the channels on the bottom of the seat. Hold the pieces together while inserting all 4 connectors through base and into the bottom of the seat. You'll see the "key holes" aligned that accept the head of the connector.

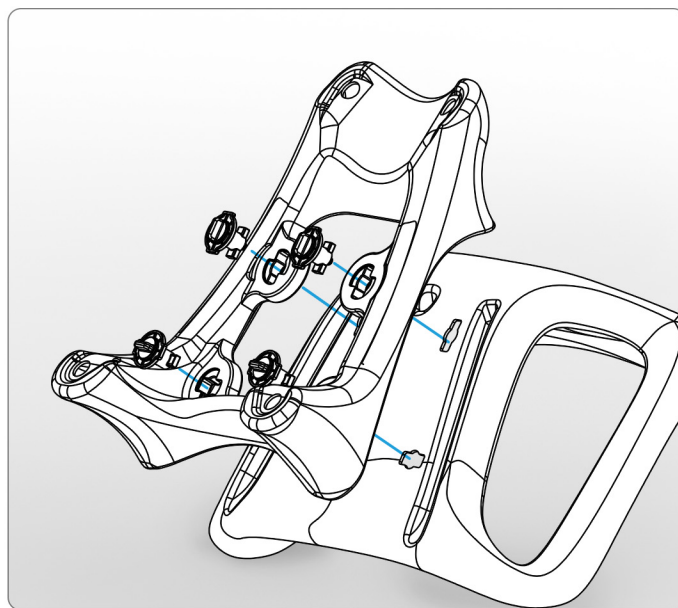

Diagram: Step 3

## Step 4

Turn the outer ring of each connector to the right (clockwise) 90 degrees. Hold this outer ring at the 90 degree position while twisting the head of the center plastic screw until it is securely tightened by hand. Do not use a pliers or tools to turn the connectors. Hand tightening is enough and assembly is complete.